



Kingfisher Lighting

Part of the LUCECO group of companies

Datasheet

STONE Series



Specification Text

The STONE shall be manufactured from die-cast aluminium. It shall have power outputs ranging from 2.0 - 10.0W, with an efficacy of up to 50 lm/W. It shall deliver 45 - 190 luminaire lumens. The STONE Range is available with a range of different distributions and sizes to suit a wide variety of projects. Available in 3000K and 4000K, the luminaire shall be IK10 and IP67 rated, with a drive over rating up to 4000kg available.

Specification

Weight: 0.7 kg - 1.9 kg
Material: ~~316L~~ Stainless Steel, Die-cast Aluminium
Paint Finish: Stainless Steel, Graphite Grey

Optics

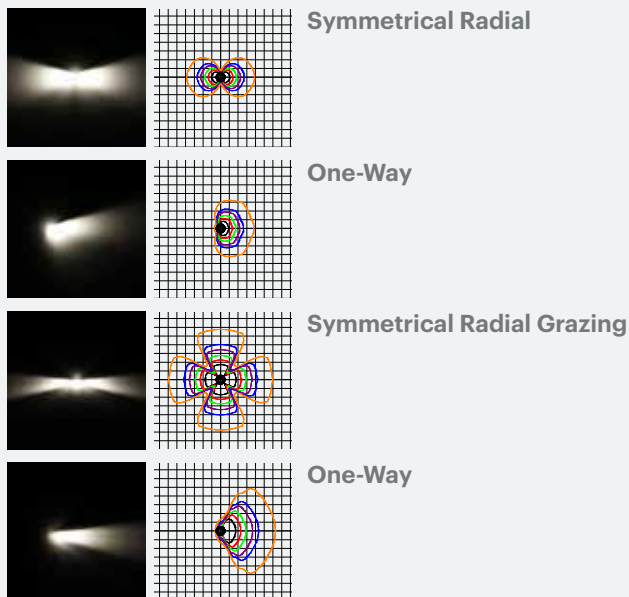

Product Description

STONE is a series of in-ground luminaires available in an array of sizes and distributions. With heavy duty drive-over options, and paired with other in-ground series', these fixtures are perfect for accenting or highlighting pathways.

Key Features

- 2.0W - 10.0W
- 45 - 190 Luminaire Lumens
- Efficacy up to 50 lm/W
- 3000K, 4000K, CRI>80
- IP67, IP68, IK10
- Lifetime 60,000, L80
- Walk over load of up to 4000kg
- PMMA Lenses for Optimal Beam Orientation
- Controls Compatible

Other Options Available

Contact for further details

- Colour Temperature Opportunities

Mounting Options

- Surface Mount

Body Type	A	B	C
STONE 55	110	110	95
STONE 180 Short	180	180	122

All measurements in mm

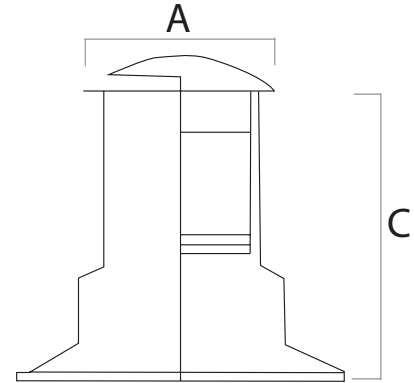

Code	Power	Luminaire Lumens	Drive Current	Optic	CCT(K)	IP	IK	Weight kg	Driver Included	Driver Type
STO55-SYR-840-2-30	2.0	100	700	Radial	4000	IP68	IK08	0.72	No	Fixed
STO55-1W-840-2-30	2.0	45	700	One-way	4000	IP68	IK10	0.75	No	Fixed
STO180S-SYR-840-10-16	10.0	190	-	Radial Grazing	4000	IP66	IK10	1.65	Yes	Fixed
STO180S-1W-840-10-16	10.0	45	-	One-way	4000	IP67	IK10	1.87	Yes	Fixed
STO180S-2W-840-10-16	10.0	90	-		4000	IP67	IK10	1.77	Yes	Fixed